

Industrial Palace Na Výstavišti

The dominant feature of the Prague Exhibition Grounds has been under reconstruction since 2022. The aim is to preserve its unique original appearance from the 19th century while equipping it with modern technologies for the 21st century.



Na Výstavišti Coming Soon Na Výstavišti Coming Soon Na Výstavišti Coming Soon Na Výstavišti Coming Soon Na Výstavišti Coming Soon

Space

- Total covered area 10,400 m²
- Right wing 3600 m² / 1800 pax gala / 3350 pax theatre
- Central Hall 1800 m² / 700 pax gala / 1750 pax theatre
- Left wing 4500 m² / 2000 pax gala / 3600 pax theatre

Advantages

- Excellent locality closed to city centre
- Great accessibility by public transport
- Convenient parking
- Possibility of hybrid events

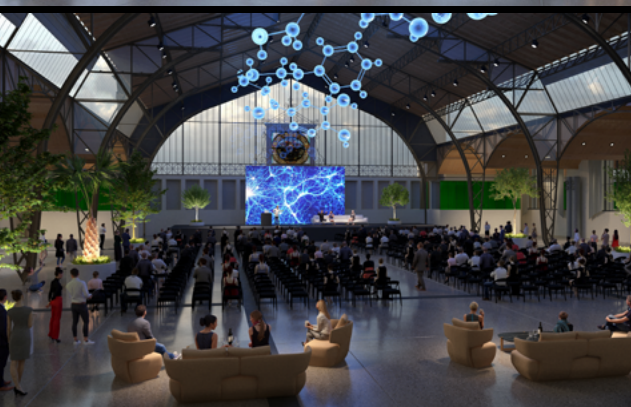

Do you have
a question?

Do not hesitate
to contact us.
www.navystaviti.cz/rent

Jan Siro
jan.siro@navystaviti.cz
+420 771 127 674

Aleš Kalný
ales.kalny@navystaviti.cz
+420 778 726 307

Marie Štegllová
marie.steglova@navystaviti.cz
+420 725 186 961